

**INTEGRUS ARCHITECTURE**  
10 SOUTH CEDAR STREET  
SPOKANE, WASHINGTON 99204  
509.838.8881 FAX 838.2194

**LMNARCHITECTS**  
801 SECOND AVENUE, SUITE 501  
SEATTLE, WASHINGTON 98104  
206.682.3460 FAX 343.9388

**CONSTRUCTION SET**  
(REVISED—BID PACKAGE 6)

**SPOKANE CONVENTION CENTER EXPANSION**

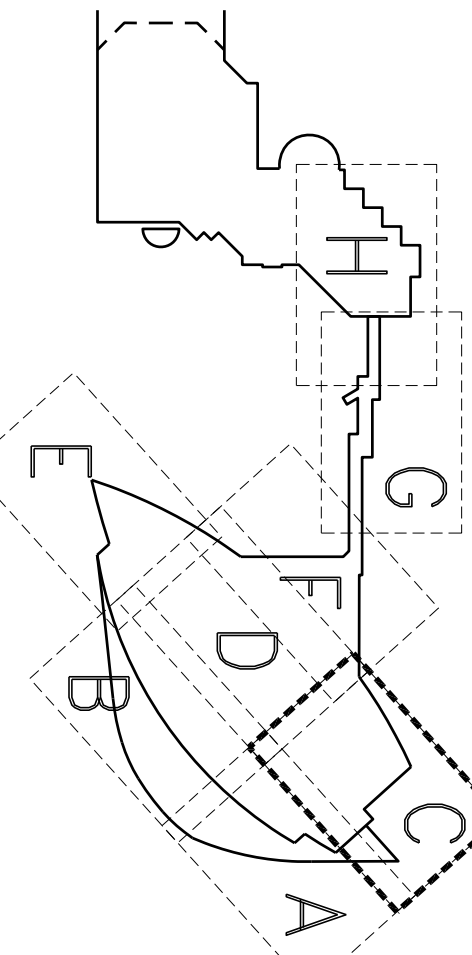

NO.	DATE	BY	DESCRIPTION
1	10-20-04		BP-1 ADDENDUM #1
2	10-28-04		BP-1 ADDENDUM #2
3	11-04-04		BP-1 ADDENDUM #3
4	01-21-05		BP-1 CLARIFICATION DWG
5	3-07-05		BP-2
6	4-15-05		CD 025

DESIGNED	_____ T.A./H
DRAWN	_____ JDC
CHECKED	_____ 4-15-05
DATE	_____ 150a--O-C.dwg
CADD FILE	_____ 20150.00
JOB NUMBER	_____ 20150.00

**PARKING LEVEL 01  
FOUNDATION - SECTOR C**

**S1.1C**

